



18 Centre Road Willows Riverside Park, Windsor, SL4 5TU
£185,000

 **HORLER**

18 Centre Road Willows Riverside Park, Windsor, SL4 5TU

A charming two-bedroom park home situated within the peaceful Willows Riverside Park in Windsor, exclusively for residents aged 50 and over. This spacious double-unit home features an open plan living and dining area, separate fitted kitchen, two bedrooms, and a bathroom. Outside offers a wrap-around garden and off-road parking. Set within a tranquil community close to local amenities, parks, and the River Thames, this property provides comfortable and relaxed living in an ideal location.



Property Summary

Nestled within the serene surroundings of Willows Riverside Park in Windsor, this charming two-bedroom park home offers a delightful retreat for those aged 50 and over. The property boasts a spacious double unit design, providing ample room for comfortable living.

As you enter, you are welcomed by an open plan living and dining area, perfect for entertaining guests or enjoying quiet evenings at home. The separate kitchen is well-equipped, allowing for easy meal preparation and culinary creativity.

The home features two inviting bedrooms, ideal for relaxation and rest. The well-appointed bathroom adds to the convenience of this lovely residence.

Outside, the property is complemented by a wrap-around garden, providing a peaceful outdoor space to enjoy the fresh air and natural beauty of the park. Additionally, off-road parking ensures that your vehicle is secure and easily accessible.

This park home is not just a place to live; it is a lifestyle choice, offering a tranquil environment within a vibrant community. With its prime location in Windsor, you will have access to local amenities, beautiful parks, and the picturesque River Thames.

This property is a perfect opportunity for those seeking a peaceful and comfortable home in a welcoming setting. Do not miss the chance to make this delightful park home your own.

General Information

Family Park/No pets

Site Fees - TBC

Avanti Gas

Council Tax - Band 'A'

Legal Note

Although these particulars are thought to be materially correct their accuracy cannot be guaranteed and they do not form part of any contract.





Centre Road SL4

Approximate Gross Internal Floor Area = 65.3 sq m / 704 sq ft

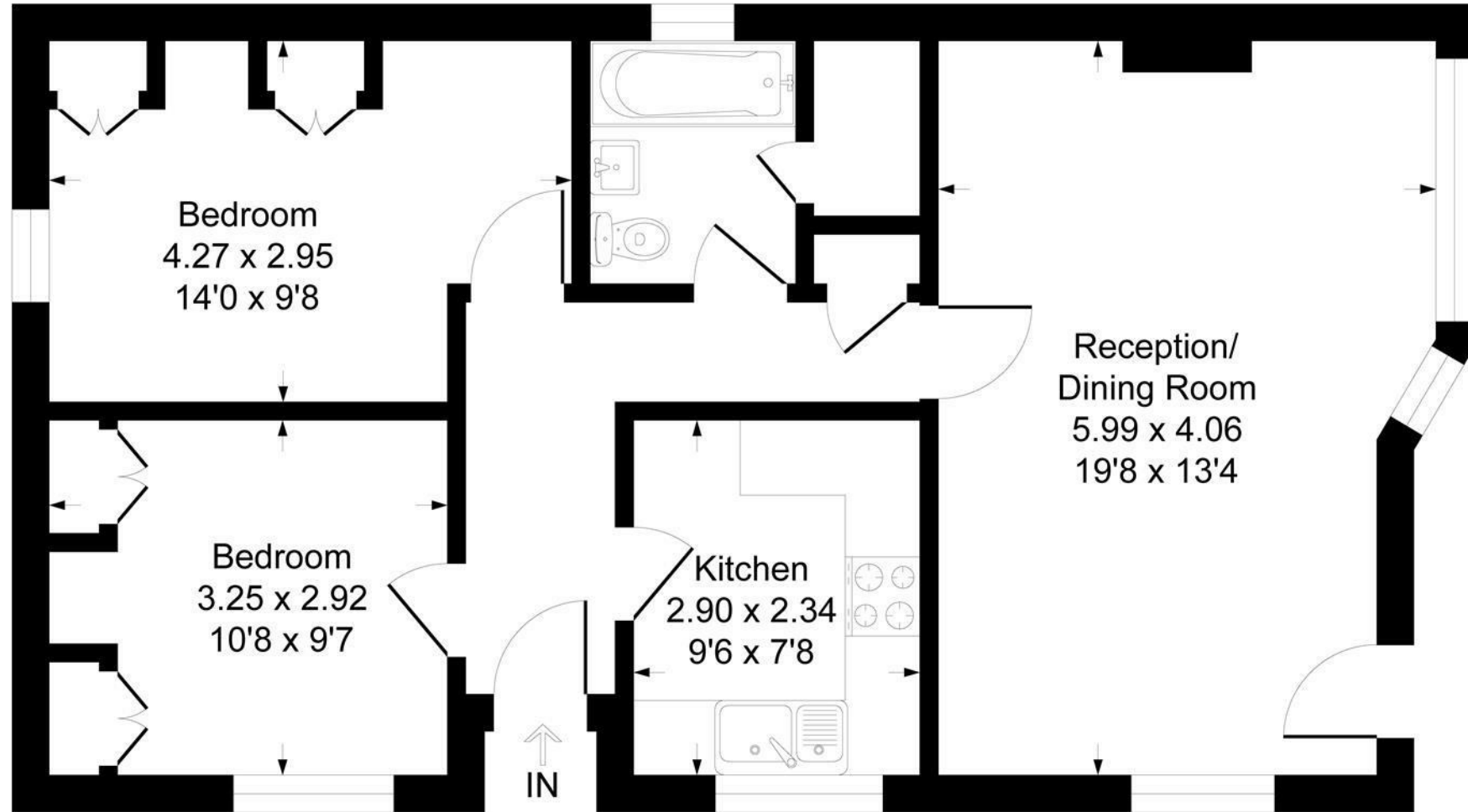

Illustration for identification purposes only, measurements are approximate, not to scale.
Produced By Esjay Property Marketing